

# TECHNICAL DATASHEET



## END CAP

03 Update - 05/2022

### TECHNICAL DATA

Article No	001 117 0140 0355
d (mm)	355
le (mm)	173
s (mm)	32,2
Weight (Kg)	8,980
Box Quantity (pcs)	1
Box Dimension (pcs)	35,5x35,5x26

### INJECTION MOULDED

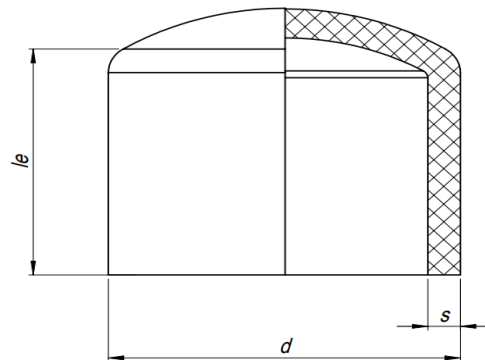

### IDENTIFICATION OF PRODUCT

D(mm)	355
SDR	11
RAW METARIAL	PE 100
PRESSURE CLASS	16 Bar Water 10 Bar Gas
TRADEMARK	NTG
EXECUTION	Injection Moulded
STANDARD	EN 12201-3 EN 1555-3 AS /NZS 4129

### SPECIFICATION

Long Spigot

*Tolerance on diameters and thickness according to the standards. The other dimensions are specialized. Tolerance  $\pm 5\%$ . NTG PLASTIK reserves all the right to change any information without giving prior notice. The production, distribution and utilization of this document without explicit authorization is prohibited.*

Fr 161 Rev 00